

## Technical data

### Wolf Cell

Pressure-resistant height adjustment

- very high compressive strength
- easy processing
- ecological material
- easy disposal
- suitable for large tile formats

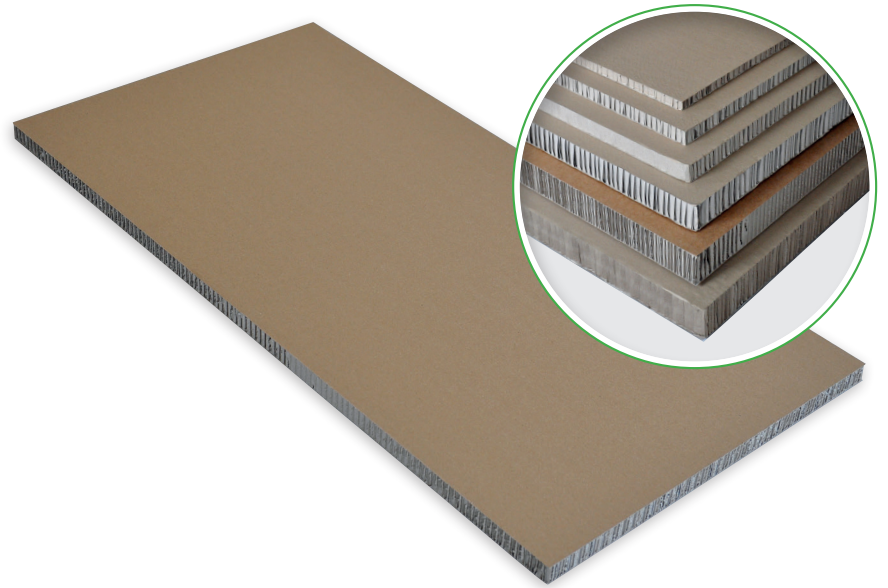

### Product description

Wolf Cell is the ecological and pressure-resistant height leveller for floor constructions.

Dimensions	Length x width ± 3 [mm]	Thickness ± 1 [mm]	Weight [kg/m <sup>2</sup> ]	Suitable for Point loads [kN]*	Surface load [kN/m <sup>2</sup> ]*	Thermal conductivity [W/(mK)]
Wolf Cell 20	1200 x 800	20	1,22	4	5	0,105
Wolf Cell 30		30	1,40			
Wolf Cell 40		40	1,72			
Wolf Cell 60		60	2,32			
Wolf Cell 80		80	3,77			

\*in conjunction with Wolf Hugo N & F.

### Storage:

- Only store Wolf Cell panels indoors, horizontally, flat, dry and frost-free
- Store at the installation site for 24 hours to acclimatise
- Protect edges from damage.